

SAMPIERDARENA OLII is a shoretank deposit in the **Port of Genoa** reachable through two pedestrian gates fitted with interphones, and three driveway gates. Premises are splitted into areas as showed in plan, which access is restricted to authorized persons and vehicles only. Basins' areas and equipments are off-limits to anybody except Sampierdarena Ollii's personnel or authorized persons.

Here below please find ISPS Code's risks and provisions of the working areas where any authorized persons coming from land may get in. All access/intervention must be carried out in accordance with the provisions contained in this document by adequate DPI.

List of main risks in working environment

Sampierdarena Ollii specify the potentially most significant risks inside the areas of their competence: running over, falling into seawaters, slipping and sliding, **collisions**, falling from height.

Adverse weather conditions produce an increase of risks!!!

Running over (due to presence of vehicles under loading, discharging, manoeuvring operations). On whole area everyone is compelled to wear high visibility clothings, showing identification card for external staff, and take the highest care. It is forbidden to enter any area without authorization.

Falling into seawaters Presence of quay with risk of falling into the sea: always keep at safety distance (about 2 meters) from the quay edge; and move with the highest care;

Falling from height Access to shoretanks stairs is restricted to authorized personnel only.

Slipping-Slidings/Collisions Take the highest care to your steps on any wet floors, paving unevenness, equipments.

General provisions:

It is mandatory to:

Turn off vehicles engines;
Make use of available trash cans,
Follow fixed paths;
Follow the provisions of **SAMPIERDARENA OLII** personnel.

It is forbidden to:

Move round in the premises.
Obstruct emergency exits and/or operational areas and passages even if only temporarily;
Smoke in whole area.

To Seamen and boarded persons

It is compulsory to:

Be authorized to enter (entry E) "notice of arrival".
Show identification card worn on.
Wear high visibility jacket while in whole area.

It is forbidden to:

Leave the recommended paths for on-board personnel.

To Shipchandlers

It is compulsory to:

Be authorized to enter (entry E for persons, entry D for Vehicles) "notice of arrival".
Show identification card worn on.
Wear high visibility jacket in case of services rendered in areas outside offices.

It is forbidden to:

Authorize admittance of personnel non included in the list as provided by the company.

Protection / Escaping Systems

Sampierdarena Ollii is fitted with :
Fire-fighting plant by seawater (inexhaustible source)
Early rescue equipments placed in operational office room.
Spillingscollection system by mean of specific booms.

Emergency administration

Danger notice: everybody is to notify any situation of imminent and serious danger.

General alarm: notification by electric siren, an acoustic signal detectable on whole area.

Everybody is to notify any people in the area to perform escaping steps.

Rules of conduct in case of emergency: Keep calm, stop any work in progress and put equipments in safety status.

Immediately clear any roads enabling free transit of any rescue vehicles; no park close to fireplugs and to fire fighting devices.

Everybody must reach meeting points as evidenced on plans overleaf, following emergency ways-out as indicated by billboards and then stay waiting for a responsible personnel.

Spilling into the sea: Immediately call enabling the activation of the necessary steps, service available any time 24 hours a day

Suggestions in case of emergency

In case of fire:

If escaping ways-out are obstructed or not viable, hold a wet handkerchief pressed on nose-mouth.
Use fire extinguisher to choke outbreaks of fire only.
Raise the alarm and call for rescue.
Go to the safe meeting points.

In case of earthquakes or shakes:

Go close to a lintel or a perimeter bearing wall, or get shelter under a work surface (desk or work bench), awaiting the shake is over.

Keep away from windows, glasses, weighty furnitures.

If escaping is ordered, follow emergency administrations provisions.

In any case, never use lift.

For any else not reported in this document please refer to company's relevant procedures and regulations in force.

For major details kindly refer to personnel in charge.

Areas splitting:

Tanks field: green colour, forbidden access to non-employees.
Operations area: orange colour, (load/unload), A, B and D entries.
Ship's area: blue colour, E entry.
Offices' area: yellow colour, C entry.

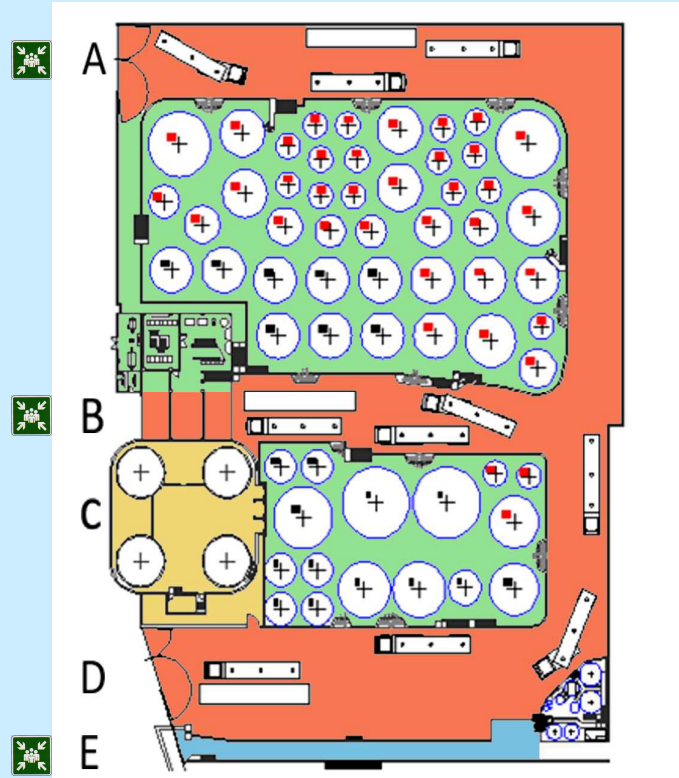

NOTES:

Handed over and explained on _____

By : _____

to (name of person) : _____

Company or Self-employed Subject : _____

Signature : _____

Notice

ENVIRONMENT, SAFETY & SECURITY

SEALINK INTERFACE

SAMPIERDARENA OLII S.r.l.

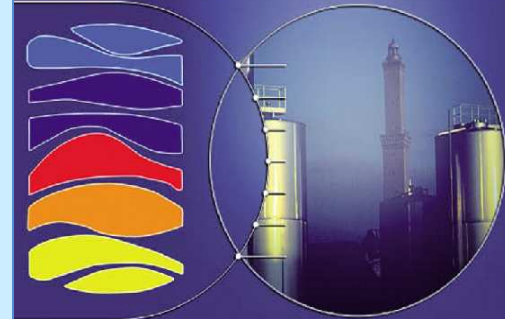

This folding document was analyzed, developed and realized by SAMPIERDARENA OLII SRL (employer) in cooperation with RSPP, RSGI and PFSO, in accordance with existing rules for safety on the workplaces, environment and the ISPS Code.

- **Seamen**
- **Boarded people**
- **Shipchandlers**